

Katalog produktów

Product catalogue

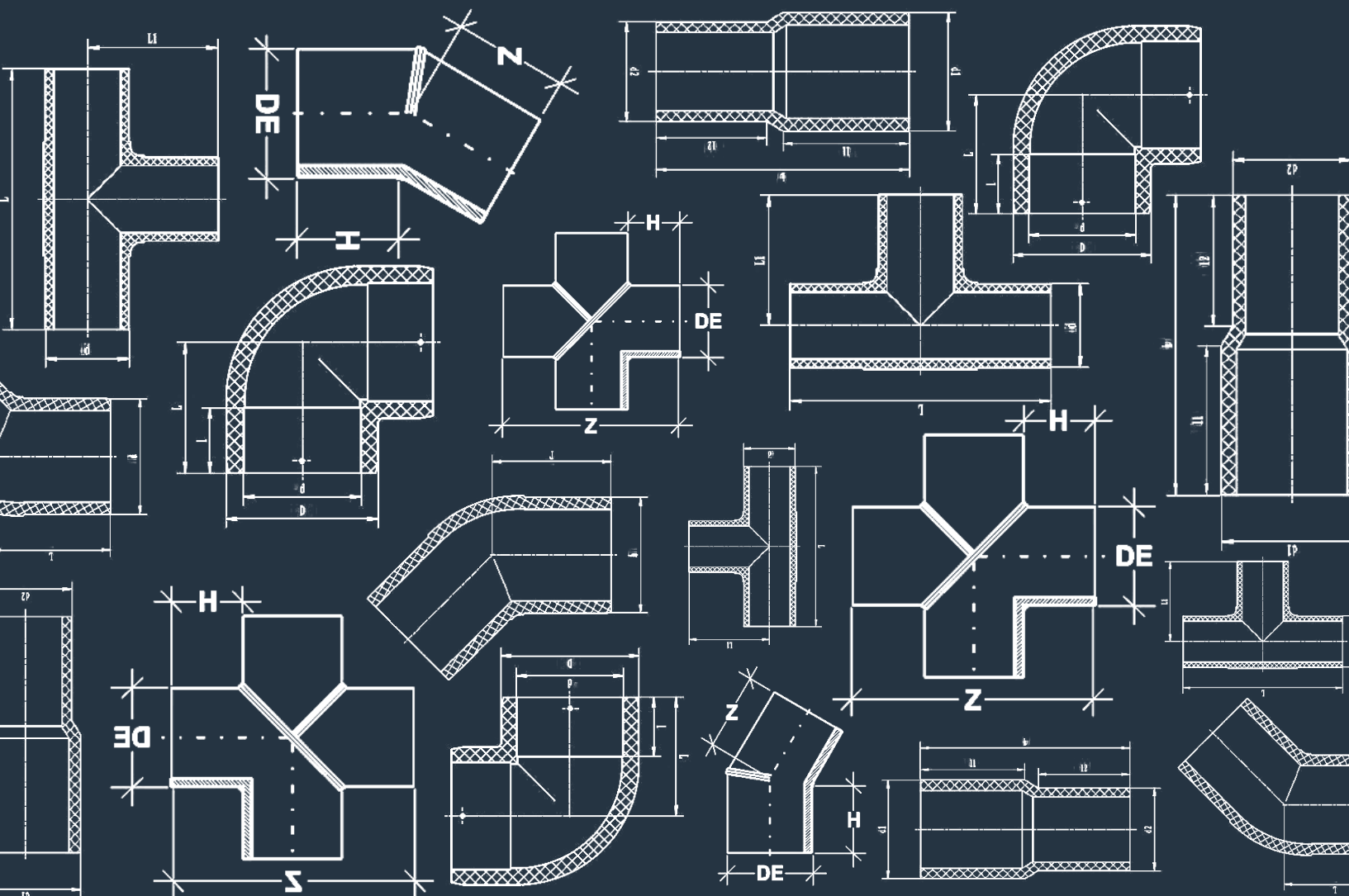

Złączki elektrooporowe i doczołowe





 **Szanowni Państwo,**

Firma MPJ Sp. z o.o. powstała w roku 1972 jako jedno z pierwszych w Polsce prywatnych przedsiębiorstw przetwarzających tworzywa sztuczne.

Wiodącym wyrobem są złączki skręcane z polipropylenu do rur PE, które zyskały duże uznanie ze strony inwestorów.

W naszej działalności od początku przyjęliśmy nowoczesny marketingowy model zarządzania firmą, nastawiony na rozpoznanie realnych potrzeb każdego klienta i ich zaspokojenie. Najwyższa jakość to motto wszelkich naszych działań – od wstępnych rozmów z klientami, poprzez wybór, doradztwo techniczne i dostawę.

Jesteśmy pierwszą w Polsce firmą produkcyjną, która wdrożyła system ISO 9001:2015 na produkcję złączek zaciskowych do łączenia rur z PE oraz sprzedaż wyrobów do wykonania instalacji teletechnicznych, wodnych i gazowych.

Potwierdzeniem naszej solidności jest szeroki krąg odbiorców z którymi współpracujemy od wielu lat, jak również brak reklamacji dotyczących jakości naszych wyrobów.

W standardzie naszego działania zapewniamy Państwu:

- szeroką gamę oferowanych produktów,
- ciągłość dostaw,
- szybką reakcję na potrzeby rynku,
- czas realizacji zamówień do 48 godz.,
- materiały reklamowe – tablice reklamowe, cenniki itp.,
- wieloletnią gwarancję na wszystkie oferowane produkty,
- miłą i sympatyczną obsługę,
- stabilność cen.

Biorąc pod uwagę nasze wieloletnie doświadczenie w branży przetwórstwa tworzyw sztucznych, jesteśmy przekonani, że możemy zaoferować więcej niż nasi konkurenci.

Zapraszamy do współpracy



Dear Sir or Madam,

The MPJ company was founded in 1972 as one of Poland's first private firms processing plastics.

The leading products are the compression fittings for PE pipes which have gained great recognition from investors.

From the start of our business we adopted a modern marketing management model, aimed at recognition and fulfilling of real needs of every customer. The top quality is the motto of all our activities – from initial talks with clients, through choice, technical advising and supply.

We are the first company in Poland to implement ISO 9001:2015 for production of compression fittings for connecting PE pipes and sales of products for teletechnical, water and gas installations.

A confirmation of our reliability is also a broad range of customers with whom we have been cooperating for many years, as well as the lack of complaints as to the quality of our products.

As a business standard we provide you with the following:

- wide scope of offered products,
- continuity of supplies,
- prompt response to market demand,
- order realization time up to 48 hrs,
- advertising materials – advertising boards, price lists, etc,
- long term guarantee for all offered products,
- nice and pleasant service
- price stability.

Considering our many years of experience in the plastics processing industry, we are convinced that we can offer more than our competitors.

We invite you to enter into cooperation

SPIS TREŚCI

| | |
|--------------------------------------------|----|
| Złącze elektrooporowe..... | 5 |
| Zgrzewarki do złączy elektrooporowych..... | 9 |
| Kształtki doczołowe..... | 10 |
| Akcesoria do zgrzewania..... | 16 |



www.mpj.pl

Złączeni elektrooporowe

Electrofusion fittings

Kształtki elektrooporowe produkowane są z surowców najwyższej jakości i przy zastosowaniu najnowocześniejszych technologii. Nie zawierają szkodliwych substancji, co umożliwia stosowanie ich przy budowie i remontach sieci wodociągowych, gazowych, kanalizacyjnych oraz w instalacjach przemysłowych.

Połączenie typu elektrooporowego to nowoczesna technologia pozwalająca na mocne, trwałe oraz bezpieczne połączenie rur polietylenowych PE 80 i PE 100 szeregu SDR 17 i SDR 11. W naszych kształtkach uzwojenie grzewcze wewnątrz złączki pokryte jest cienką warstwą polietylenu. Zapobiega to i ochrania drut oporowy przed uszkodzeniem mechanicznym podczas procesu grzewczego przy wprowadzaniu zgrzewanych końców rur do kształtki.

Zgrzewanie można wykonać przy użyciu zgrzewarek o napięciu 39,5 V przy pomocy czytnika i kodu paskowego naklejonego na kształtkę lub wprowadzając parametry zgrzewania wytłoczone na kształtkę w sposób manualny.

Electrofusion fittings are produced from the top quality raw materials, with the use of most modern technologies. Do not contain injurious materials what makes possible their usage in building and renovation of water supplies, gas supplies, sewage and industrial installations.

The electroresisting type connection is the modern technology which enables strong, permanent and the secure connecting of polyethylene pipes PE 80 and PE 100 of SDR 17 and SDR 11. In our electrofusion fittings the resisting wire inside fitting is applied by thin coat of the polyethylene. This prevents and protects the resisting wire before the mechanical damage during the process of weld when welded ends of pipes are pushed into the electrofusion fitting.

The pressure welding can be performed by using automatic welders with the tension of the pressure welding 39,5 V by bar code scanner or manually.



Zasada montażu złączek elektrooporowych

Electrofusion fittings assembly method



Krok 1

Upewnij się, że końcówki rur są gładkie i proste.

Step 1

Assure that the pipes ends are smooth and straight.

Krok 2

Zmierz poziomą długość pomiędzy końcem złączki, a ogranicznikiem (zmierz pół długości złączki bez ogranicznika).

Step 2

Measure the horizontal length between the fitting end and the limit circle (measure half length of the fitting without limit circle).



Krok 3

Zaznacz na rurze powyższą długość (długość wkładania).

Step 3

Mark the pipe with the above length (inserting length).



Krok 4

Wyczyść miejsce zgrzewu rury i złączki acetonem, wysusz całkowicie miejsce zgrzewu czystą szmatką. Nie dotykaj czystego i suchego miejsca zgrzewu na rurze i złączce.

Step 4

Clean the fusion area of the pipe and fitting with acetone, completely dry the fusion area with clean cloth. Do not touch the clean and dry pipe and fitting with hands.

Krok 5

Zedrzyj utlenioną warstwę rury (0,1-0,3 mm), usuń zadziory na końcówkach rur.

Step 5

Scrape the oxidized layer of the pipe (around 0,1 - 0,3mm), remove the burrs on the pipes ends.



Krok 6

Umieść rurę w złączce elektrooporowej i ustaw na zaznaczonej wcześniej długości, następnie sprawdź dopasowanie złączki.

Step 6

Insert the pipe into the electrofusion fitting and stop at the length mark, then check the size fitness.



Krok 7

Zaciśnij rurę oraz złączkę na tej samej osi, nie ruszaj podczas zgrzewania.

Step 7

Clamp the pipe and fitting at the same axis, do not move during welding.



Krok 8

Wsuń całkowicie końcówki od zgrzewarki elektrooporowej do gniazd złączki.

Step 8

Stick completely the plugs of the welding machine into the sockets of the fitting.



Krok 9

Wczytaj kod kreskowy na złączce skanerem kodów kreskowych lub wpisz ręcznie parametry zgrzewu.

Step 9

Read the bar code on the fitting by scanner or input the welding parameters manually.



Krok 10

Sprawdź współczynnik zgrzewania na zgrzewarce elektrooporowej (typ produkcji, napięcie, czas zgrzewania i chłodzenia).

Step 10

Check the welding coefficient showed on the machine (production type, voltage, heating and cooling time).



Krok 11

Naciśnij „START” aby kontynuować zgrzewanie. Nie dotykaj zacisków podczas zgrzewania.

Step 11

Press "START" button to carry on welding. Do not touch the clamp during welding.

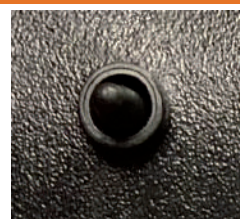

Krok 12

Sprawdź czy wskaźniki zgrzewania są wysunięte (wysokość wskaźników zgrzewania zmienia się wraz z odstępem między rurą a złączką).

Step 12

Check if the welding indicators are protruded (the welding indicator's height vary with fit clearance between the pipe and fitting).

MUFA ELEKTROOPOROWA RÓWNOPRZELOTOWA
ELECTROFUSION COUPLER

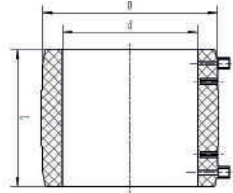

| Nr kat. | d | D | L | SDR | PN(bar) | U/B | Waga (kg) |
|---------|-----|-----|-----|-----------|---------|-----|-----------|
| EZP20 | 20 | 32 | 73 | 11 - 17.6 | 16 | 80 | 0,063 |
| EZP25 | 25 | 40 | 70 | 11 - 17.6 | 16 | 60 | 0,070 |
| EZP32 | 32 | 47 | 77 | 11 - 17.6 | 16 | 50 | 0,090 |
| EZP40 | 40 | 56 | 85 | 11 - 17.6 | 16 | 40 | 0,123 |
| EZP50 | 50 | 68 | 94 | 11 - 17.6 | 16 | 40 | 0,168 |
| EZP63 | 63 | 81 | 113 | 11 - 17.6 | 16 | 30 | 0,243 |
| EZP75 | 75 | 96 | 125 | 11 - 17.6 | 16 | 20 | 0,365 |
| EZP90 | 90 | 116 | 160 | 11 - 17.6 | 16 | 10 | 0,670 |
| EZP110 | 110 | 141 | 155 | 11 - 17.6 | 16 | 16 | 0,656 |
| EZP125 | 125 | 159 | 160 | 11 - 17.6 | 16 | 10 | 0,930 |
| EZP140 | 140 | 177 | 165 | 11 - 17.6 | 16 | 10 | 1,538 |
| EZP160 | 160 | 203 | 170 | 11 - 17.6 | 16 | 6 | 1,800 |
| EZP180 | 180 | 230 | 180 | 11 - 17.6 | 16 | 5 | 1,860 |
| EZP200 | 200 | 254 | 195 | 11 - 17.6 | 16 | 4 | 2,833 |
| EZP225 | 225 | 279 | 210 | 11 - 17.6 | 16 | 3 | 4,500 |
| EZP250 | 250 | 312 | 220 | 11 - 17.6 | 16 | 2 | 5,350 |
| EZP280 | 280 | 348 | 260 | 11 - 17.6 | 16 | 2 | 7,250 |
| EZP315 | 315 | 392 | 285 | 11 - 17.6 | 16 | 1 | 8,800 |
| EZP355 | 355 | 429 | 290 | 11 - 17.6 | 16 | 1 | 8,300 |
| EZP400 | 400 | 455 | 400 | 11 - 17.6 | 16 | 1 | 11,200 |

ZAŚLEPKA ELEKTROOPOROWA
ELECTROFUSION CAP

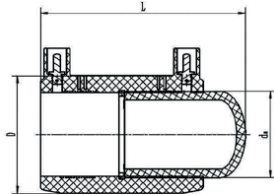

| Nr kat. | d | D | L | SDR | PN(bar) | U/B | Waga (kg) |
|---------|-----|-----|-------|-----------|---------|-----|-----------|
| EZS20 | 20 | 30 | 70 | 11 - 17.6 | 16 | 50 | 0,050 |
| EZS25 | 25 | 40 | 79 | 11 - 17.6 | 16 | 50 | 0,082 |
| EZS32 | 32 | 47 | 95 | 11 - 17.6 | 16 | 50 | 0,100 |
| EZS40 | 40 | 56 | 98 | 11 - 17.6 | 16 | 50 | 0,152 |
| EZS50 | 50 | 68 | 118.5 | 11 - 17.6 | 16 | 40 | 0,430 |
| EZS63 | 63 | 81 | 140 | 11 - 17.6 | 16 | 50 | 0,332 |
| EZS75 | 75 | 96 | 157 | 11 - 17.6 | 16 | 36 | 0,483 |
| EZS90 | 90 | 116 | 188 | 11 - 17.6 | 16 | 18 | 0,928 |
| EZS110 | 110 | 141 | 202 | 11 - 17.6 | 16 | 10 | 1,120 |
| EZS125 | 125 | 159 | 206 | 11 - 17.6 | 16 | 6 | 1,625 |
| EZS160 | 160 | 203 | 219 | 11 - 17.6 | 16 | 3 | 2,933 |
| EZS200 | 200 | 254 | 289 | 11 - 17.6 | 16 | 1 | 4,750 |

MUFA ELEKTROOPOROWA REDUKCYJNA
ELECTROFUSION REDUCER

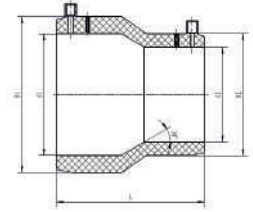

| Nr kat. | d1-d2 | D1 | D2 | L | SDR | PN | U/B | Waga (kg) |
|-----------|---------|-----|-----|-----|-----------|----|-----|-----------|
| EZR2520 | 25-20 | 34 | 29 | 69 | 11 - 17.6 | 16 | 60 | 0,040 |
| EZR3220 | 32-20 | 47 | 29 | 76 | 11 - 17.6 | 16 | 60 | 0,050 |
| EZR3225 | 32-25 | 47 | 40 | 90 | 11 - 17.6 | 16 | 60 | 0,093 |
| EZR4025 | 40-25 | 56 | 40 | 89 | 11 - 17.6 | 16 | 50 | 0,100 |
| EZR4032 | 40-32 | 56 | 47 | 95 | 11 - 17.6 | 16 | 50 | 0,120 |
| EZR5025 | 50-25 | 68 | 40 | 100 | 11 - 17.6 | 16 | 40 | 0,140 |
| EZR5032 | 50-32 | 68 | 47 | 108 | 11 - 17.6 | 16 | 40 | 0,158 |
| EZR5040 | 50-40 | 68 | 56 | 107 | 11 - 17.6 | 16 | 40 | 0,160 |
| EZR6325 | 63-25 | 81 | 40 | 102 | 11 - 17.6 | 16 | 30 | 0,180 |
| EZR6332 | 63-32 | 81 | 47 | 126 | 11 - 17.6 | 16 | 30 | 0,200 |
| EZR6340 | 63-40 | 81 | 56 | 125 | 11 - 17.6 | 16 | 30 | 0,223 |
| EZR6350 | 63-50 | 81 | 68 | 122 | 11 - 17.6 | 16 | 30 | 0,243 |
| EZR7563 | 75-63 | 96 | 81 | 135 | 11 - 17.6 | 16 | 20 | 0,350 |
| EZR9050 | 90-50 | 116 | 68 | 155 | 11 - 17.6 | 16 | 12 | 0,467 |
| EZR9063 | 90-63 | 116 | 81 | 148 | 11 - 17.6 | 16 | 12 | 1,475 |
| EZR9075 | 90-75 | 116 | 96 | 146 | 11 - 17.6 | 16 | 12 | 0,542 |
| EZR11063 | 110-63 | 141 | 81 | 178 | 11 - 17.6 | 16 | 16 | 0,775 |
| EZR11075 | 110-75 | 141 | 96 | 176 | 11 - 17.6 | 16 | 16 | 0,844 |
| EZR11090 | 110-90 | 141 | 116 | 175 | 11 - 17.6 | 16 | 16 | 0,894 |
| EZR12563 | 125-63 | 159 | 81 | 187 | 11 - 17.6 | 16 | 12 | 1,000 |
| EZR12590 | 125-90 | 159 | 116 | 184 | 11 - 17.6 | 16 | 12 | 1,133 |
| EZR125110 | 125-110 | 159 | 141 | 163 | 11 - 17.6 | 16 | 12 | 1,150 |
| EZR16090 | 160-90 | 203 | 116 | 220 | 11 - 17.6 | 16 | 6 | 1,883 |
| EZR160110 | 160-110 | 203 | 141 | 210 | 11 - 17.6 | 16 | 6 | 2,033 |
| EZR160125 | 160-125 | 203 | 159 | 192 | 11 - 17.6 | 16 | 6 | 1,917 |
| EZR20090 | 200-90 | 254 | 117 | 265 | 11 - 17.6 | 16 | 3 | 3,700 |
| EZR200110 | 200-110 | 254 | 142 | 254 | 11 - 17.6 | 16 | 3 | 3,500 |
| EZR200160 | 200-160 | 256 | 204 | 220 | 11 - 17.6 | 16 | 3 | 3,567 |
| EZR250160 | 250-160 | 314 | 204 | 273 | 11 - 17.6 | 16 | 2 | 5,500 |
| EZR250200 | 250-200 | 314 | 254 | 245 | 11 - 17.6 | 16 | 2 | 2,850 |
| EZR315200 | 315-200 | 396 | 254 | 350 | 11 - 17.6 | 16 | 1 | 10,000 |
| EZR315250 | 315-250 | 396 | 318 | 340 | 11 - 17.6 | 16 | 1 | 10,300 |

KOLANO ELEKTROOPOROWE 90°
ELECTROFUSION ELBOW 90°

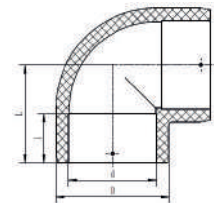

| Nr kat. | d | D | L | I | SDR | PN | U/B | Waga (kg) |
|---------|-----|-----|-----|-----|-----------|----|-----|-----------|
| EKP25 | 25 | 24 | 55 | 38 | 11 - 17.6 | 16 | 60 | 0,103 |
| EKP32 | 32 | 47 | 62 | 41 | 11 - 17.6 | 16 | 50 | 0,128 |
| EKP40 | 40 | 56 | 71 | 46 | 11 - 17.6 | 16 | 40 | 0,185 |
| EKP50 | 50 | 68 | 63 | 53 | 11 - 17.6 | 16 | 20 | 0,275 |
| EKP63 | 63 | 81 | 100 | 61 | 11 - 17.6 | 16 | 12 | 0,400 |
| EKP75 | 75 | 40 | 55 | 38 | 11 - 17.6 | 16 | 10 | 0,580 |
| EKP90 | 90 | 94 | 111 | 66 | 11 - 17.6 | 16 | 6 | 1,000 |
| EKP110 | 110 | 116 | 122 | 70 | 11 - 17.6 | 16 | 8 | 1,688 |
| EKP125 | 125 | 141 | 145 | 82 | 11 - 17.6 | 16 | 6 | 2,167 |
| EKP160 | 160 | 177 | 168 | 90 | 11 - 17.6 | 16 | 4 | 4,200 |
| EKP180 | 180 | 203 | 182 | 94 | 11 - 17.6 | 16 | 4 | 4,150 |
| EKP200 | 200 | 230 | 198 | 99 | 11 - 17.6 | 16 | 2 | 8,200 |
| EKP250 | 250 | 257 | 215 | 105 | 11 - 17.6 | 16 | 1 | 8,300 |

KOLANO ELEKTROOPOROWE 45° ELECTROFUSION ELBOW 45°

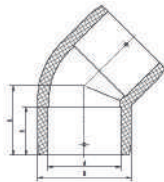

| Nr kat. | d | D | L | I | SDR | PN | U/B | Waga (kg) |
|----------|-----|-----|-----|-----|-----------|----|-----|-----------|
| EKP3245 | 32 | 47 | 54 | 41 | 11 - 17.6 | 16 | 60 | 0,125 |
| EKP4045 | 40 | 56 | 62 | 46 | 11 - 17.6 | 16 | 30 | 0,163 |
| EKP5045 | 50 | 68 | 70 | 53 | 11 - 17.6 | 16 | 25 | 0,240 |
| EKP6345 | 63 | 81 | 80 | 61 | 11 - 17.6 | 16 | 12 | 0,333 |
| EKP7545 | 75 | 94 | 88 | 66 | 11 - 17.6 | 16 | 12 | 0,492 |
| EKP9045 | 90 | 116 | 95 | 70 | 11 - 17.6 | 16 | 6 | 0,750 |
| EKP11045 | 110 | 141 | 115 | 82 | 11 - 17.6 | 16 | 12 | 1,458 |
| EKP12545 | 125 | 159 | 118 | 85 | 11 - 17.6 | 16 | 6 | 1,567 |
| EKP16045 | 160 | 203 | 138 | 94 | 11 - 17.6 | 16 | 4 | 3,250 |
| EKP18045 | 180 | 230 | 147 | 99 | 11 - 17.6 | 16 | 2 | 5,900 |
| EKP20045 | 200 | 254 | 165 | 105 | 11 - 17.6 | 16 | 2 | 6,150 |
| EKP25045 | 250 | 316 | 191 | 120 | 11 - 17.6 | 16 | 1 | 8,300 |

TRÓJNIK SIODŁOWY ELECTROFUSION TAPPING TEE

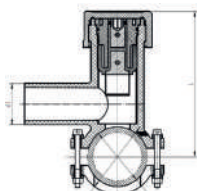

| Nr kat. | d-d1 | D | L | SDR | PN | U/B | Waga (kg) |
|----------|--------|-----|-----|-----------|----|-----|-----------|
| ETS4032 | 40-32 | 55 | 141 | 11 - 17.6 | 16 | 30 | 0,370 |
| ETS5032 | 50-32 | 66 | 110 | 11 - 17.6 | 16 | 30 | 0,370 |
| ETS6332 | 63-32 | 78 | 139 | 11 - 17.6 | 16 | 10 | 2,180 |
| ETS6340 | 63-40 | 78 | 155 | 11 - 17.6 | 16 | 25 | 0,470 |
| ETS7532 | 75-32 | 91 | 141 | 11 - 17.6 | 16 | 25 | 0,440 |
| ETS9032 | 90-32 | 114 | 221 | 11 - 17.6 | 16 | 20 | 0,510 |
| ETS9040 | 90-40 | 105 | 186 | 11 - 17.6 | 16 | 20 | 0,650 |
| ETS9063 | 90-63 | 114 | 221 | 11 - 17.6 | 16 | 3 | 2,567 |
| ETS11032 | 110-32 | 124 | 216 | 11 - 17.6 | 16 | 10 | 0,920 |
| ETS11040 | 110-40 | 130 | 176 | 11 - 17.6 | 16 | 10 | 0,950 |
| ETS11063 | 110-63 | 134 | 231 | 11 - 17.6 | 16 | 10 | 2,760 |
| ETS12532 | 125-32 | 140 | 215 | 11 - 17.6 | 16 | 10 | 1,010 |
| ETS12540 | 125-40 | 150 | 178 | 11 - 17.6 | 16 | 10 | 1,030 |
| ETS12563 | 125-63 | 160 | 178 | 11 - 17.6 | 16 | 10 | 1,100 |
| ETS16032 | 160-32 | 180 | 122 | 11 - 17.6 | 16 | 6 | 2,460 |
| ETS16063 | 160-63 | 194 | 271 | 11 - 17.6 | 16 | 10 | 2,720 |
| ETS20063 | 200-63 | 240 | 294 | 11 - 17.6 | 16 | 5 | 3,820 |

ODGAŁĘZIENIE SIODŁOWE ELECTROFUSION BRANCHING SADDLE

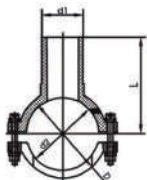

| Nr kat. | d2-d1 | D | L | SDR | PN(bar) | U/B | Waga (kg) |
|----------|--------|-----|-----|-----------|---------|-----|-----------|
| EOS4032 | 40-32 | 50 | 106 | 11 - 17.6 | 16 | 50 | 0,240 |
| EOS5032 | 50-32 | 72 | 107 | 11 - 17.6 | 16 | 50 | 0,260 |
| EOS6332 | 63-32 | 78 | 99 | 11 - 17.6 | 16 | 20 | 0,550 |
| EOS7532 | 75-32 | 53 | 118 | 11 - 17.6 | 16 | 25 | 0,360 |
| EOS9032 | 90-32 | 114 | 117 | 11 - 17.6 | 16 | 10 | 0,900 |
| EOS9063 | 90-63 | 110 | 202 | 11 - 17.6 | 16 | 20 | 1,080 |
| EOS11032 | 110-32 | 134 | 121 | 11 - 17.6 | 16 | 7 | 1,314 |
| EOS11063 | 110-63 | 134 | 147 | 11 - 17.6 | 16 | 6 | 1,217 |
| EOS12532 | 125-32 | 147 | 164 | 11 - 17.6 | 16 | 12 | 1,200 |
| EOS12563 | 125-63 | 154 | 157 | 11 - 17.6 | 16 | 6 | 1,267 |
| EOS16032 | 160-32 | 175 | 145 | 11 - 17.6 | 16 | 10 | 1,650 |
| EOS16363 | 163-63 | 194 | 177 | 11 - 17.6 | 16 | 6 | 1,867 |
| EOS20063 | 200-63 | 240 | 200 | 11 - 17.6 | 16 | 8 | 1,500 |
| EOS20090 | 200-90 | 230 | 190 | 11 - 17.6 | 16 | 6 | 1,900 |
| EOS25063 | 250-63 | 300 | 230 | 11 - 17.6 | 16 | 6 | 3,183 |

TRÓJNIK RÓWNOPRZELOTOWY ELECTROFUSION EQUAL TEE

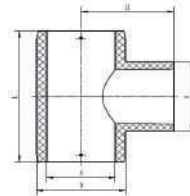

| Nr kat. | d | D | L | L1 | SDR | PN | U/B | Waga (kg) |
|---------|-----|-----|-----|-----|-----------|----|-----|-----------|
| ETP25 | 25 | 40 | 100 | 64 | 11 - 17.6 | 16 | 40 | 0,120 |
| ETP32 | 32 | 47 | 110 | 70 | 11 - 17.6 | 16 | 40 | 0,130 |
| ETP40 | 40 | 56 | 127 | 80 | 11 - 17.6 | 16 | 30 | 0,200 |
| ETP50 | 50 | 68 | 156 | 100 | 11 - 17.6 | 16 | 15 | 0,400 |
| ETP63 | 63 | 81 | 178 | 122 | 11 - 17.6 | 16 | 10 | 0,450 |
| ETP75 | 75 | 96 | 191 | 131 | 11 - 17.6 | 16 | 7 | 0,660 |
| ETP90 | 90 | 116 | 226 | 144 | 11 - 17.6 | 16 | 10 | 1,140 |
| ETP110 | 110 | 141 | 255 | 160 | 11 - 17.6 | 16 | 8 | 1,740 |
| ETP125 | 125 | 159 | 270 | 175 | 11 - 17.6 | 16 | 5 | 2,300 |
| ETP160 | 160 | 203 | 317 | 211 | 11 - 17.6 | 16 | 3 | 4,370 |
| ETP180 | 180 | 230 | 341 | 241 | 11 - 17.6 | 16 | 1 | 8,200 |
| ETP200 | 200 | 254 | 400 | 255 | 11 - 17.6 | 16 | 1 | 8,500 |
| ETP250 | 250 | 318 | 450 | 310 | 11 - 17.6 | 16 | 1 | 8,900 |
| ETP315 | 315 | 396 | 640 | 390 | 11 - 17.6 | 16 | 1 | 14,600 |

TRÓJNIK REDUKCYJNY ELECTROFUSION REDUCED TEE

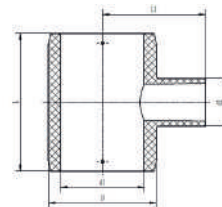

| Nr kat. | d2-d1 | D | L | L1 | SDR | PN | U/B | Waga (kg) |
|-----------|---------|-----|-----|-----|-----------|----|-----|-----------|
| ETR3225 | 32-25 | 47 | 110 | 63 | 11 - 17.6 | 16 | 40 | 0,125 |
| ETR4025 | 40-25 | 56 | 120 | 72 | 11 - 17.6 | 16 | 30 | 0,183 |
| ETR4032 | 40-32 | 56 | 130 | 75 | 11 - 17.6 | 16 | 30 | 0,188 |
| ETR5025 | 50-25 | 68 | 146 | 78 | 11 - 17.6 | 16 | 18 | 0,311 |
| ETR5032 | 50-32 | 68 | 146 | 81 | 11 - 17.6 | 16 | 18 | 0,322 |
| ETR5040 | 50-40 | 68 | 146 | 81 | 11 - 17.6 | 16 | 18 | 0,333 |
| ETR6325 | 63-25 | 81 | 156 | 86 | 11 - 17.6 | 16 | 12 | 0,258 |
| ETR6332 | 63-32 | 81 | 156 | 90 | 11 - 17.6 | 16 | 12 | 0,333 |
| ETR6340 | 63-40 | 81 | 156 | 94 | 11 - 17.6 | 16 | 12 | 0,350 |
| ETR6350 | 63-50 | 81 | 156 | 98 | 11 - 17.6 | 16 | 12 | 0,346 |
| ETR7563 | 75-63 | 96 | 178 | 115 | 11 - 17.6 | 16 | 10 | 0,383 |
| ETR9040 | 90-40 | 116 | 200 | 115 | 11 - 17.6 | 16 | 15 | 0,833 |
| ETR9050 | 90-50 | 116 | 200 | 125 | 11 - 17.6 | 16 | 15 | 0,847 |
| ETR9063 | 90-63 | 125 | 200 | 125 | 11 - 17.6 | 16 | 15 | 0,873 |
| ETR9075 | 90-75 | 125 | 200 | 125 | 11 - 17.6 | 16 | 15 | 0,900 |
| ETR11040 | 110-40 | 141 | 220 | 125 | 11 - 17.6 | 16 | 10 | 1,230 |
| ETR11050 | 110-50 | 141 | 220 | 125 | 11 - 17.6 | 16 | 10 | 1,370 |
| ETR11063 | 110-63 | 141 | 220 | 150 | 11 - 17.6 | 16 | 8 | 1,425 |
| ETR11075 | 110-75 | 141 | 220 | 150 | 11 - 17.6 | 16 | 8 | 1,450 |
| ETR11090 | 110-90 | 141 | 220 | 160 | 11 - 17.6 | 16 | 8 | 1,488 |
| ETR12563 | 125-63 | 159 | 220 | 150 | 11 - 17.6 | 16 | 6 | 1,933 |
| ETR12590 | 125-90 | 159 | 245 | 165 | 11 - 17.6 | 16 | 6 | 2,000 |
| ETR125110 | 125-110 | 203 | 257 | 171 | 11 - 17.6 | 16 | 6 | 2,217 |
| ETR16063 | 160-63 | 203 | 238 | 182 | 11 - 17.6 | 16 | 4 | 2,850 |
| ETR16090 | 160-90 | 203 | 277 | 198 | 11 - 17.6 | 16 | 4 | 3,300 |
| ETR160110 | 160-110 | 203 | 277 | 198 | 11 - 17.6 | 16 | 4 | 3,600 |
| ETR160125 | 160-125 | 230 | 290 | 206 | 11 - 17.6 | 16 | 4 | 3,650 |
| ETR20090 | 200-90 | 254 | 285 | 215 | 11 - 17.6 | 16 | 2 | 5,450 |
| ETR200110 | 200-110 | 254 | 310 | 220 | 11 - 17.6 | 16 | 2 | 5,850 |
| ETR200160 | 200-160 | 254 | 360 | 240 | 11 - 17.6 | 16 | 2 | 7,100 |

Zgrzewarki elektrooporowe

Electrofusion welders



| | ZK90PRO | ZK160PRO | ZK315PRO | ZK400PRO |
|-----------------------------------------------------------------------------------------|-------------------|-------------------|-------------------|-------------------|
| Maksymalny zakres roboczy | 125mm* | 160mm* | 355mm* | 400mm* |
| Moc wyjściowa (W) | 1500 | 2000 | 2600 | 3300 |
| Zalecany agregat | 3,5 ÷ 4 kVA | 3,5 ÷ 4 kVA | 5,5 ÷ 6 kVA | 5,5 ÷ 6 kVA |
| Napięcie zasilania | 230 V ± 15% | 230 V ± 15% | 230 V ± 15% | 230 V ± 15% |
| Częstotliwość napięcia zasilania | 50 - 60 Hz | 50 - 60 Hz | 50 - 60 Hz | 50 - 60 Hz |
| Napięcie zgrzewania | 8 - 48 V | 8 - 48 V | 8 - 48 V | 8 - 48 V |
| Nastawa automatyczna (kod kreskowy ręcznie) | TAK | TAK | TAK | TAK |
| Nastawa automatyczna (kod kreskowy czytnikiem) | TAK | TAK | TAK | TAK |
| Nastawa manualna | TAK | TAK | TAK | TAK |
| Możliwość zgrywania danych na pamięć przenośną (pendrive) | TAK | TAK | TAK | TAK |
| Pojemność pamięci zgrzewów | 400 | 400 | 400 | 400 |
| Oprogramowanie do generowania protokołów zgrzewania | TAK (do pobrania) | TAK (do pobrania) | TAK (do pobrania) | TAK (do pobrania) |
| Wyświetlacz alfanumeryczny 4 wiersze po 20 znaków | TAK | TAK | TAK | TAK |
| Podgląd parametrów zasilania (napięcie, częstotliwość) na ekranie zgrzewarki | TAK | TAK | TAK | TAK |
| Przegląd historii wykonanych zgrzewów na ekranie zgrzewarki | TAK | TAK | TAK | TAK |
| Klawiatura alfanumeryczna do wprowadzania danych operatora, lokalizacji i opisu zgrzewu | TAK | TAK | TAK | TAK |
| Ręczne wpisywanie współrzędnych GPS zgrzewu, odczytanych z zewnętrznego odbiornika | TAK | TAK | TAK | TAK |
| Wbudowany odbiornik GPS do automatycznego zapisu współrzędnych GPS | opcja | opcja | opcja | opcja |
| Pokrowiec ochronny na czytnik kodów kreskowych | TAK | TAK | TAK | TAK |
| Mocna, pyłoszczelna obudowa zewnętrzna z tworzywa sztucznego | TAK | TAK | TAK | TAK |
| Elektronika zgrzewarki chroniona metalowym korpusem | TAK | TAK | TAK | TAK |
| Możliwość samodzielnej aktualizacji oprogramowania poprzez pendrive | TAK | TAK | TAK | TAK |
| Długość przewodu zasilania (m) | 3 | 3 | 3 | 3 |
| Długość przewodu grzewczego (m) | 3 | 3 | 3 | 3 |
| Wymiary (mm) | 470 x 365 x 190 | 470 x 365 x 190 | 470 x 365 x 190 | 470 x 365 x 190 |
| Stopień ochrony | IP 54 | IP 54 | IP 54 | IP 54 |
| Klasa ochronności | I | I | I | I |
| Waga (kg) | 16 | 19,8 | 22 | 27 |
| Gwarancja (miesiące) | 24 | 24 | 24 | 24 |

* Podana maksymalna średnica zgrzewania jest wartością przybliżoną. Zależnie od typu oraz producenta elektroizolacji może być niższa lub wyższa.

Kształtki doczołowe

Spigot fittings

KSZTAŁTKI DOCZOŁOWE

System kształtek do zgrzewania doczołowego oferowany przez naszą firmę, produkowany jest metodą wtryskową z PE100. Nasz asortyment to kompletne rozwiązanie do budowy sieci gazowych, wodociągowych, kanalizacji ciśnieniowych oraz instalacji przemysłowych.

Bogaty asortyment kształtek doczołowych służących do łączenia rurociągów polietylenowych, zarówno w SDR17 jak i SDR11 w średnicach od \varnothing 20 do \varnothing 400, umożliwia użytkownikowi optymalny wybór rozwiązania i pomaga przy projektowaniu sieci.

Zgrzewanie rur i kształtek PE metodą doczołową polega na odpowiednim nagraniu i uplastycznieniu końców łączonych elementów w styku z płytą grzewczą. Po jej usunięciu, następuje dociśnięcie końców do siebie i naturalne schłodzenie połączenia. Końce zgrzewanych elementów nie mogą być zanieczyszczone i uszkodzone mechanicznie. Przygotowanie łączonych elementów polega na wyrównaniu ich powierzchni czołowych tak, żeby powierzchnie te były wzajemnie równoległe, równe w całym przekroju i pozbawione warstwy utlenionego materiału. Łączone elementy powinny być ustawione w zgrzewarce współosiowo. Po wstawieniu płyty grzewczej i uplastycznieniu końców elementów, te są od niej odsuwane, a sama płyta zostaje wyjęta. Następnie elementy są do siebie dociskane, a ich powierzchnie stygną. Podczas dociskania do siebie łączonych elementów, uplastyczniony materiał jest wyciskany na zewnątrz i do wewnątrz, formując wałeczki wypływki. Ten etap procesu zgrzewania powinien być wykonywany w taki sposób, aby jak największa część zdegradowanego materiału została usunięta na zewnątrz. Zgrzewanie doczołowe nie powinno być wykonywane podczas złych warunków atmosferycznych, w temperaturze otoczenia poniżej 0°C , jak również w czasie mgły - niezależnie od temperatury. W takich przypadkach sugeruje się zastosowanie namiotu chroniącego miejsce zgrzewania.

THE SPIGOT FITTINGS

The spigot fittings system offered by our company, is produced using the injection method of PE100. Our range of products is a complete solution for installation of gas systems, water supply, sewerage systems, pressure sewage systems and industrial installations.

The broad choice of offered spigot fittings for connection of PE pipelines, both with SDR17 and SDR11 with diameters from \varnothing 20 to \varnothing 400, enables user to select the optimum solution and helps in the process of designing the system.

The butt fusion welding of PE pipes and fittings involves proper heating and plastifying jointed ends by contact with heating plate. After removing the plate, the ends are pressed one to another and the connection is cooled down naturally. Ends of fusion welded elements may not be dirty nor have mechanical damages. Preparation of jointed elements involves planing the butting surfaces flush and making the entire cross section even and free of oxidized material layer. Jointed elements should be aligned axially in the welding machine. After inserting the heating plate and heating up the ends of elements, they are taken out, the plate is removed, the elements are pressed one to another and their surfaces are cooled. During the process of pressing together the jointed elements the plasticized material is pushed into the outside and the inside of the joint forming rolled flashes. This stage of the welding process should be carried out in such a way that as much of the degraded material as possible is removed outside. Butt welding should not be carried out during bad weather conditions, at ambient temperature of below 0°C , as well as in the fog - regardless of the temperature. In such case it is suggested to use special tent for protecting the welding site.

TRÓJNIK RÓWNOPRZELOTOWY SDR11 PE100 EQUAL TEE SDR11 PE100

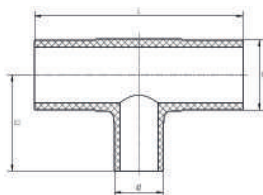

| Nr kat. | D | l | le | z | s |
|-------------|-----|-----|-----|-----|------|
| DTP20SDR11 | 20 | 135 | 41 | 69 | 3,0 |
| DTP25SDR11 | 25 | 145 | 41 | 74 | 3,0 |
| DTP32SDR11 | 32 | 157 | 44 | 80 | 3,0 |
| DTP40SDR11 | 40 | 183 | 49 | 93 | 3,7 |
| DTP50SDR11 | 50 | 222 | 55 | 113 | 4,6 |
| DTP63SDR11 | 63 | 239 | 63 | 123 | 5,8 |
| DTP75SDR11 | 75 | 273 | 70 | 139 | 6,8 |
| DTP90SDR11 | 90 | 301 | 79 | 153 | 8,2 |
| DTP110SDR11 | 110 | 337 | 82 | 171 | 10,0 |
| DTP125SDR11 | 125 | 367 | 87 | 186 | 11,4 |
| DTP140SDR11 | 140 | 384 | 92 | 195 | 12,7 |
| DTP160SDR11 | 160 | 428 | 98 | 217 | 14,6 |
| DTP180SDR11 | 180 | 472 | 105 | 239 | 16,4 |
| DTP200SDR11 | 200 | 488 | 112 | 247 | 18,2 |
| DTP225SDR11 | 225 | 534 | 120 | 270 | 20,5 |
| DTP250SDR11 | 250 | 597 | 129 | 302 | 22,7 |
| DTP280SDR11 | 280 | 698 | 139 | 353 | 25,4 |
| DTP315SDR11 | 315 | 726 | 150 | 388 | 28,6 |

TRÓJNIK RÓWNOPRZELOTOWY SDR17 PE100 EQUAL TEE SDR17 PE100

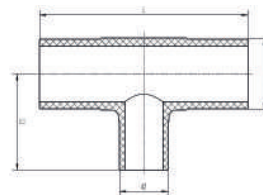

| Nr kat. | D | l | le | z | s |
|-------------|-----|-----|-----|-----|------|
| DTP63SDR17 | 63 | 239 | 63 | 123 | 3,8 |
| DTP75SDR17 | 75 | 273 | 70 | 139 | 4,5 |
| DTP90SDR17 | 90 | 301 | 79 | 153 | 5,4 |
| DTP110SDR17 | 110 | 337 | 82 | 171 | 6,6 |
| DTP125SDR17 | 125 | 367 | 87 | 186 | 7,4 |
| DTP140SDR17 | 140 | 384 | 92 | 195 | 8,3 |
| DTP160SDR17 | 160 | 428 | 98 | 217 | 9,5 |
| DTP180SDR17 | 180 | 472 | 105 | 239 | 10,7 |
| DTP200SDR17 | 200 | 488 | 112 | 247 | 11,9 |
| DTP225SDR17 | 225 | 534 | 120 | 270 | 13,4 |
| DTP250SDR17 | 250 | 597 | 129 | 302 | 14,8 |
| DTP280SDR17 | 280 | 698 | 139 | 353 | 16,6 |
| DTP315SDR17 | 315 | 726 | 150 | 388 | 18,7 |

TRÓJNIK REDUKCYJNY SDR11 PE100
REDUCED TEE SDR11 PE100

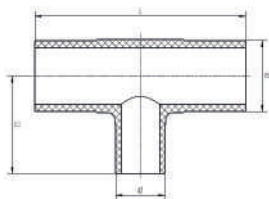

| Nr kat. | D (mm) | l | le1 | le2 | z | s1 | s2 |
|----------------|-----------|-----|-----|-----|-----|------|------|
| DTR5025SDR11 | 50 x 25 | 222 | 55 | 41 | 85 | 5,8 | 3,0 |
| DTR5032SDR11 | 50 x 32 | 222 | 55 | 44 | 92 | 5,8 | 3,0 |
| DTR5040SDR11 | 50 x 40 | 222 | 55 | 49 | 98 | 5,8 | 3,7 |
| DTR6332SDR11 | 63 x 32 | 239 | 63 | 44 | 98 | 5,8 | 3,0 |
| DTR6340SDR11 | 63 x 40 | 239 | 63 | 49 | 104 | 5,8 | 3,7 |
| DTR6350SDR11 | 63 x 50 | 239 | 63 | 55 | 111 | 5,8 | 4,6 |
| DTR7532SDR11 | 75 x 32 | 273 | 70 | 44 | 105 | 6,8 | 3,0 |
| DTR7540SDR11 | 75 x 40 | 273 | 70 | 49 | 111 | 6,8 | 3,7 |
| DTR7550SDR11 | 75 x 50 | 273 | 70 | 55 | 118 | 6,8 | 4,6 |
| DTR9050SDR11 | 90 x 50 | 301 | 79 | 55 | 129 | 8,2 | 4,6 |
| DTR9063SDR11 | 90 x 63 | 301 | 79 | 63 | 137 | 8,2 | 5,8 |
| DTR9075SDR11 | 90 x 75 | 301 | 79 | 70 | 144 | 8,2 | 6,8 |
| DTR11050SDR11 | 110 x 50 | 337 | 82 | 55 | 152 | 10,0 | 4,6 |
| DTR11063SDR11 | 110 x 63 | 337 | 82 | 63 | 154 | 10,0 | 5,8 |
| DTR11075SDR11 | 110 x 75 | 337 | 82 | 70 | 160 | 10,0 | 6,8 |
| DTR11090SDR11 | 110 x 90 | 337 | 82 | 79 | 167 | 10,0 | 8,2 |
| DTR12590SDR11 | 125 x 90 | 367 | 87 | 79 | 177 | 11,4 | 8,2 |
| DTR125110SDR11 | 125 x 110 | 367 | 87 | 82 | 181 | 11,4 | 10,0 |
| DTR14090SDR11 | 140 x 90 | 384 | 92 | 79 | 180 | 12,7 | 8,2 |
| DTR140110SDR11 | 140 x 110 | 384 | 92 | 82 | 185 | 12,7 | 10,0 |
| DTR140125SDR11 | 140 x 125 | 384 | 92 | 87 | 190 | 12,7 | 11,4 |
| DTR16063SDR11 | 160 x 63 | 428 | 98 | 63 | 181 | 14,6 | 5,8 |
| DTR16075SDR11 | 160 x 75 | 428 | 98 | 70 | 188 | 14,6 | 6,8 |
| DTR16090SDR11 | 160 x 90 | 428 | 98 | 79 | 197 | 14,6 | 8,2 |
| DTR160110SDR11 | 160 x 110 | 428 | 98 | 82 | 201 | 14,6 | 10,0 |
| DTR160125SDR11 | 160 x 125 | 428 | 98 | 87 | 206 | 14,6 | 11,4 |
| DTR18090SDR11 | 180 x 90 | 472 | 105 | 79 | 212 | 16,4 | 8,2 |
| DTR180110SDR11 | 180 x 110 | 472 | 105 | 82 | 216 | 16,4 | 10,0 |
| DTR180125SDR11 | 180 x 125 | 472 | 105 | 87 | 221 | 16,4 | 11,4 |
| DTR180160SDR11 | 180 x 160 | 472 | 105 | 98 | 232 | 16,4 | 14,6 |
| DTR20063SDR11 | 200 x 63 | 488 | 112 | 63 | 197 | 18,2 | 5,8 |
| DTR20090SDR11 | 200 x 90 | 488 | 112 | 79 | 213 | 18,2 | 8,2 |
| DTR200110SDR11 | 200 x 110 | 488 | 112 | 82 | 217 | 18,2 | 10,0 |
| DTR200125SDR11 | 200 x 125 | 488 | 112 | 87 | 232 | 18,2 | 11,4 |
| DTR200160SDR11 | 200 x 160 | 488 | 112 | 98 | 233 | 18,2 | 14,6 |
| DTR22590SDR11 | 225 x 90 | 534 | 120 | 79 | 229 | 20,5 | 8,2 |
| DTR225110SDR11 | 225 x 110 | 534 | 120 | 82 | 233 | 20,5 | 10,0 |
| DTR225125SDR11 | 225 x 125 | 534 | 120 | 87 | 246 | 20,5 | 11,4 |
| DTR225160SDR11 | 225 x 160 | 534 | 120 | 98 | 249 | 20,5 | 14,6 |
| DTR25090SDR11 | 250 x 90 | 597 | 129 | 79 | 250 | 22,7 | 8,2 |
| DTR250110SDR11 | 250 x 110 | 597 | 129 | 82 | 254 | 22,7 | 10,0 |
| DTR250125SDR11 | 250 x 125 | 597 | 129 | 87 | 259 | 22,7 | 11,4 |
| DTR250160SDR11 | 250 x 160 | 597 | 129 | 98 | 270 | 22,7 | 14,6 |
| DTR250225SDR11 | 250 x 225 | 597 | 129 | 120 | 292 | 22,7 | 20,5 |
| DTR280110SDR11 | 280 x 110 | 698 | 139 | 82 | 294 | 25,4 | 10,0 |
| DTR280160SDR11 | 280 x 160 | 698 | 139 | 98 | 310 | 25,4 | 14,6 |
| DTR280200SDR11 | 280 x 200 | 698 | 139 | 112 | 324 | 25,4 | 18,2 |
| DTR280225SDR11 | 280 x 225 | 698 | 139 | 120 | 332 | 25,4 | 20,5 |
| DTR280250SDR11 | 280 x 250 | 698 | 139 | 129 | 342 | 25,4 | 22,7 |
| DTR315110SDR11 | 315 x 110 | 726 | 150 | 82 | 297 | 28,6 | 10,0 |
| DTR315160SDR11 | 315 x 160 | 726 | 150 | 98 | 313 | 28,6 | 14,6 |
| DTR315200SDR11 | 315 x 200 | 726 | 150 | 112 | 327 | 28,6 | 18,2 |
| DTR315225SDR11 | 315 x 225 | 726 | 150 | 120 | 335 | 28,6 | 20,5 |
| DTR315250SDR11 | 315 x 250 | 726 | 150 | 129 | 345 | 28,6 | 22,7 |

TRÓJNIK REDUKCYJNY SDR17 PE100
REDUCED TEE SDR17 PE100

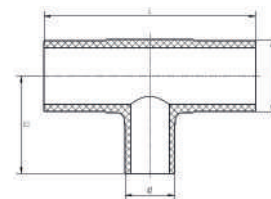

| Nr kat. | D (mm) | l | le1 | le2 | z | s1 | s2 |
|----------------|-----------|-----|-----|-----|-----|------|------|
| DTR7563SDR17 | 75 x 63 | 273 | 70 | 63 | 126 | 4,5 | 3,8 |
| DTR9063SDR17 | 90 x 63 | 301 | 79 | 63 | 137 | 5,4 | 3,8 |
| DTR9075SDR17 | 90 x 75 | 301 | 79 | 70 | 144 | 5,4 | 4,5 |
| DTR11063SDR17 | 110 x 63 | 337 | 82 | 63 | 154 | 6,6 | 3,8 |
| DTR11075SDR17 | 110 x 75 | 337 | 82 | 70 | 160 | 6,6 | 4,5 |
| DTR11090SDR17 | 110 x 90 | 337 | 82 | 79 | 167 | 6,6 | 5,4 |
| DTR12590SDR17 | 125 x 90 | 367 | 87 | 79 | 177 | 7,4 | 5,4 |
| DTR125110SDR17 | 125 x 110 | 367 | 87 | 82 | 181 | 7,4 | 6,6 |
| DTR14090SDR17 | 140 x 90 | 384 | 92 | 79 | 180 | 8,3 | 5,4 |
| DTR140110SDR17 | 140 x 110 | 384 | 92 | 82 | 185 | 8,3 | 6,6 |
| DTR140125SDR17 | 140 x 125 | 384 | 92 | 87 | 190 | 8,3 | 7,4 |
| DTR16063SDR17 | 160 x 63 | 428 | 98 | 63 | 181 | 9,5 | 3,8 |
| DTR16075SDR17 | 160 x 75 | 428 | 98 | 70 | 188 | 9,5 | 4,5 |
| DTR16090SDR17 | 160 x 90 | 428 | 98 | 79 | 197 | 9,5 | 5,4 |
| DTR160110SDR17 | 160 x 110 | 428 | 98 | 82 | 201 | 9,5 | 6,6 |
| DTR160125SDR17 | 160 x 125 | 428 | 98 | 87 | 206 | 9,5 | 7,4 |
| DTR18090SDR17 | 180 x 90 | 472 | 105 | 79 | 212 | 10,7 | 5,4 |
| DTR180110SDR17 | 180 x 110 | 472 | 105 | 82 | 216 | 10,7 | 6,6 |
| DTR180125SDR17 | 180 x 125 | 472 | 105 | 87 | 221 | 10,7 | 7,4 |
| DTR180160SDR17 | 180 x 160 | 472 | 105 | 98 | 232 | 10,7 | 9,5 |
| DTR20063SDR17 | 200 x 63 | 488 | 112 | 63 | 197 | 11,9 | 3,8 |
| DTR20090SDR17 | 200 x 90 | 488 | 112 | 79 | 213 | 11,9 | 5,4 |
| DTR200110SDR17 | 200 x 110 | 488 | 112 | 82 | 217 | 11,9 | 6,6 |
| DTR200125SDR17 | 200 x 125 | 488 | 112 | 87 | 232 | 11,9 | 7,4 |
| DTR200160SDR17 | 200 x 160 | 488 | 112 | 98 | 233 | 11,9 | 9,5 |
| DTR22590SDR17 | 225 x 90 | 534 | 120 | 79 | 229 | 13,4 | 5,4 |
| DTR225110SDR17 | 225 x 110 | 534 | 120 | 82 | 233 | 13,4 | 6,6 |
| DTR225125SDR17 | 225 x 125 | 534 | 120 | 87 | 246 | 13,4 | 7,4 |
| DTR225160SDR17 | 225 x 160 | 534 | 120 | 98 | 249 | 13,4 | 9,5 |
| DTR25090SDR17 | 250 x 90 | 597 | 129 | 79 | 250 | 14,8 | 5,4 |
| DTR250110SDR17 | 250 x 110 | 597 | 129 | 82 | 254 | 14,8 | 6,6 |
| DTR250125SDR17 | 250 x 125 | 597 | 129 | 87 | 259 | 14,8 | 7,4 |
| DTR250160SDR17 | 250 x 160 | 597 | 129 | 98 | 270 | 14,8 | 9,5 |
| DTR250225SDR17 | 250 x 225 | 597 | 129 | 120 | 292 | 14,8 | 13,4 |
| DTR280110SDR17 | 280 x 110 | 698 | 139 | 82 | 294 | 16,6 | 6,6 |
| DTR280160SDR17 | 280 x 160 | 698 | 139 | 98 | 310 | 16,6 | 9,5 |
| DTR280200SDR17 | 280 x 200 | 698 | 139 | 112 | 324 | 16,6 | 11,9 |
| DTR280225SDR17 | 280 x 225 | 698 | 139 | 120 | 332 | 16,6 | 13,4 |
| DTR280250SDR17 | 280 x 250 | 698 | 139 | 129 | 342 | 16,6 | 14,8 |
| DTR315110SDR17 | 315 x 110 | 726 | 150 | 82 | 297 | 18,7 | 6,6 |
| DTR315160SDR17 | 315 x 160 | 726 | 150 | 98 | 313 | 18,7 | 9,5 |
| DTR315200SDR17 | 315 x 200 | 726 | 150 | 112 | 327 | 18,7 | 11,9 |
| DTR315225SDR17 | 315 x 225 | 726 | 150 | 120 | 335 | 18,7 | 13,4 |
| DTR315250SDR17 | 315 x 250 | 726 | 150 | 129 | 345 | 18,7 | 14,8 |

**KOLANO 90° SDR11 PE100
ELBOW 90° SDR11 PE100**



| Nr kat. | D | le | z | s |
|-------------|-----|-----|-----|------|
| DKP20SDR11 | 20 | 41 | 62 | 3,0 |
| DKP25SDR11 | 25 | 41 | 65 | 3,0 |
| DKP32SDR11 | 32 | 44 | 71 | 3,0 |
| DKP40SDR11 | 40 | 49 | 80 | 3,7 |
| DKP50SDR11 | 50 | 55 | 96 | 4,6 |
| DKP63SDR11 | 63 | 63 | 118 | 5,8 |
| DKP75SDR11 | 75 | 70 | 133 | 6,8 |
| DKP90SDR11 | 90 | 79 | 148 | 8,2 |
| DKP110SDR11 | 110 | 82 | 152 | 10,0 |
| DKP125SDR11 | 125 | 87 | 175 | 11,4 |
| DKP140SDR11 | 140 | 92 | 207 | 12,7 |
| DKP160SDR11 | 160 | 98 | 210 | 14,6 |
| DKP180SDR11 | 180 | 105 | 226 | 16,4 |
| DKP200SDR11 | 200 | 112 | 253 | 18,2 |
| DKP225SDR11 | 225 | 120 | 270 | 20,5 |
| DKP250SDR11 | 250 | 129 | 300 | 22,7 |
| DKP280SDR11 | 280 | 139 | 348 | 25,4 |
| DKP315SDR11 | 315 | 150 | 380 | 28,6 |

**KOLANO 45° SDR11 PE100
ELBOW 45° SDR11 PE100**



| Nr kat. | D | le | z | s |
|---------------|-----|-----|-----|------|
| DKP2045SDR11 | 20 | 41 | 70 | 3,0 |
| DKP2545SDR11 | 25 | 41 | 75 | 3,0 |
| DKP3245SDR11 | 32 | 44 | 80 | 3,0 |
| DKP4045SDR11 | 40 | 49 | 85 | 3,7 |
| DKP5045SDR11 | 50 | 55 | 90 | 4,6 |
| DKP6345SDR11 | 63 | 63 | 95 | 5,8 |
| DKP7545SDR11 | 75 | 70 | 105 | 6,8 |
| DKP9045SDR11 | 90 | 79 | 120 | 8,2 |
| DKP11045SDR11 | 110 | 82 | 130 | 10,0 |
| DKP12545SDR11 | 125 | 87 | 140 | 11,4 |
| DKP14045SDR11 | 140 | 92 | 150 | 12,7 |
| DKP16045SDR11 | 160 | 98 | 160 | 14,6 |
| DKP18045SDR11 | 180 | 105 | 170 | 16,4 |
| DKP20045SDR11 | 200 | 112 | 185 | 18,2 |
| DKP22545SDR11 | 225 | 120 | 200 | 20,5 |
| DKP25045SDR11 | 250 | 129 | 217 | 22,7 |
| DKP28045SDR11 | 280 | 139 | 238 | 25,4 |
| DKP31545SDR11 | 315 | 150 | 256 | 28,6 |

**KOLANO 30° SDR11 PE100
ELBOW 30° SDR11 PE100**

| Nr kat. | D | le | z | s |
|---------------|-----|-----|-----|------|
| DKP9030SDR11 | 90 | 100 | 160 | 8,2 |
| DKP11030SDR11 | 110 | 150 | 219 | 10,0 |
| DKP12530SDR11 | 125 | 150 | 225 | 11,4 |
| DKP14030SDR11 | 140 | 150 | 231 | 12,7 |
| DKP16030SDR11 | 160 | 150 | 239 | 14,6 |
| DKP18030SDR11 | 180 | 150 | 247 | 16,4 |
| DKP20030SDR11 | 200 | 150 | 255 | 18,2 |
| DKP22530SDR11 | 225 | 150 | 266 | 20,5 |
| DKP25030SDR11 | 250 | 250 | 385 | 22,7 |
| DKP28030SDR11 | 280 | 250 | 400 | 25,4 |
| DKP31530SDR11 | 315 | 250 | 460 | 28,6 |
| DKP35530SDR11 | 355 | 300 | 540 | 32,3 |
| DKP40030SDR11 | 400 | 300 | 560 | 36,4 |
| DKP45030SDR11 | 450 | 300 | 580 | 40,9 |
| DKP50030SDR11 | 500 | 350 | 630 | 45,5 |

**KOLANO 90° SDR17 PE100
ELBOW 90° SDR17 PE100**



| Nr kat. | D | le | z | s |
|-------------|-----|-----|-----|------|
| DKP63SDR17 | 63 | 63 | 118 | 3,8 |
| DKP75SDR17 | 75 | 70 | 133 | 4,5 |
| DKP90SDR17 | 90 | 79 | 148 | 5,4 |
| DKP110SDR17 | 110 | 82 | 152 | 6,6 |
| DKP125SDR17 | 125 | 87 | 175 | 7,4 |
| DKP140SDR17 | 140 | 92 | 207 | 8,3 |
| DKP160SDR17 | 160 | 98 | 210 | 9,5 |
| DKP180SDR17 | 180 | 105 | 226 | 10,7 |
| DKP200SDR17 | 200 | 112 | 253 | 11,9 |
| DKP225SDR17 | 225 | 120 | 270 | 13,4 |
| DKP250SDR17 | 250 | 129 | 300 | 14,8 |
| DKP280SDR17 | 280 | 139 | 348 | 16,6 |
| DKP315SDR17 | 315 | 150 | 380 | 18,7 |

**KOLANO 45° SDR17 PE100
ELBOW 45° SDR17 PE100**



| Nr kat. | D | le | z | s |
|---------------|-----|-----|-----|------|
| DKP6345SDR17 | 63 | 63 | 95 | 3,8 |
| DKP7545SDR17 | 75 | 70 | 105 | 4,5 |
| DKP9045SDR17 | 90 | 79 | 120 | 5,4 |
| DKP11045SDR17 | 110 | 82 | 130 | 6,6 |
| DKP12545SDR17 | 125 | 87 | 140 | 7,4 |
| DKP14045SDR17 | 140 | 92 | 150 | 8,3 |
| DKP16045SDR17 | 160 | 98 | 160 | 9,5 |
| DKP18045SDR17 | 180 | 105 | 170 | 10,7 |
| DKP20045SDR17 | 200 | 112 | 185 | 11,9 |
| DKP22545SDR17 | 225 | 120 | 200 | 13,4 |
| DKP25045SDR17 | 250 | 129 | 217 | 14,8 |
| DKP28045SDR17 | 280 | 139 | 238 | 16,6 |
| DKP31545SDR17 | 315 | 150 | 256 | 18,7 |

**KOLANO 30° SDR17 PE100
ELBOW 30° SDR17 PE100**



| Nr kat. | D | le | z | s |
|---------------|-----|-----|-----|------|
| DKP9030SDR17 | 90 | 100 | 160 | 5,4 |
| DKP11030SDR17 | 110 | 150 | 219 | 6,6 |
| DKP12530SDR17 | 125 | 150 | 225 | 7,4 |
| DKP14030SDR17 | 140 | 150 | 231 | 8,3 |
| DKP16030SDR17 | 160 | 150 | 239 | 9,5 |
| DKP18030SDR17 | 180 | 150 | 247 | 10,7 |
| DKP20030SDR17 | 200 | 150 | 255 | 11,9 |
| DKP22530SDR17 | 225 | 150 | 266 | 13,4 |
| DKP25030SDR17 | 250 | 250 | 385 | 14,8 |
| DKP28030SDR17 | 280 | 250 | 400 | 16,6 |
| DKP31530SDR17 | 315 | 250 | 460 | 18,7 |
| DKP35530SDR17 | 355 | 300 | 540 | 21,1 |
| DKP40030SDR17 | 400 | 300 | 560 | 23,7 |
| DKP45030SDR17 | 450 | 300 | 580 | 26,7 |
| DKP50030SDR17 | 500 | 350 | 650 | 29,7 |

REDUKCJA SDR 11 PE100
REDUCER SDR 11 PE100

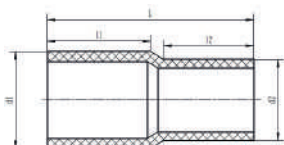

| Nr kat. | D (mm) | l | l1 | l2 | s1 | s2 |
|----------------|-----------|-----|-----|-----|------|------|
| DZR2520SDR11 | 25 x 20 | 123 | 41 | 41 | 3,0 | 3,0 |
| DZR3220SDR11 | 32 x 20 | 125 | 44 | 41 | 3,0 | 3,0 |
| DZR3225SDR11 | 32 x 25 | 133 | 44 | 41 | 3,0 | 3,0 |
| DZR4025SDR11 | 40 x 25 | 133 | 49 | 41 | 3,7 | 3,0 |
| DZR4032SDR11 | 40 x 32 | 133 | 49 | 44 | 3,7 | 3,0 |
| DZR5025SDR11 | 50 x 25 | 144 | 55 | 41 | 4,6 | 3,0 |
| DZR5032SDR11 | 50 x 32 | 144 | 55 | 44 | 4,6 | 3,0 |
| DZR5040SDR11 | 50 x 40 | 144 | 55 | 49 | 4,6 | 3,7 |
| DZR6325SDR11 | 63 x 25 | 155 | 63 | 41 | 5,8 | 3,0 |
| DZR6332SDR11 | 63 x 32 | 155 | 63 | 44 | 5,8 | 3,0 |
| DZR6340SDR11 | 63 x 40 | 155 | 63 | 49 | 5,8 | 3,7 |
| DZR6350SDR11 | 63 x 50 | 155 | 63 | 55 | 5,8 | 4,6 |
| DZR7532SDR11 | 75 x 32 | 175 | 70 | 44 | 6,8 | 3,0 |
| DZR7540SDR11 | 75 x 40 | 175 | 70 | 49 | 6,8 | 3,7 |
| DZR7550SDR11 | 75 x 50 | 175 | 70 | 55 | 6,8 | 4,6 |
| DZR7563SDR11 | 75 x 63 | 175 | 70 | 63 | 6,8 | 5,8 |
| DZR9050SDR11 | 90 x 50 | 195 | 79 | 55 | 8,2 | 4,6 |
| DZR9063SDR11 | 90 x 63 | 195 | 79 | 63 | 8,2 | 5,8 |
| DZR9075SDR11 | 90 x 75 | 195 | 79 | 70 | 8,2 | 6,8 |
| DZR11063SDR11 | 110 x 63 | 213 | 82 | 63 | 10,0 | 5,8 |
| DZR11075SDR11 | 110 x 75 | 213 | 82 | 70 | 10,0 | 6,8 |
| DZR11090SDR11 | 110 x 90 | 213 | 82 | 79 | 10,0 | 8,2 |
| DZR12563SDR11 | 125 x 63 | 220 | 87 | 63 | 11,4 | 5,8 |
| DZR12575SDR11 | 125 x 75 | 220 | 87 | 70 | 11,4 | 6,8 |
| DZR12590SDR11 | 125 x 90 | 220 | 87 | 79 | 11,4 | 8,2 |
| DZR125110SDR11 | 125 x 110 | 220 | 87 | 82 | 11,4 | 10,0 |
| DZR14075SDR11 | 140 x 75 | 231 | 92 | 70 | 12,7 | 6,8 |
| DZR14090SDR11 | 140 x 90 | 231 | 92 | 79 | 12,7 | 8,2 |
| DZR140110SDR11 | 140 x 110 | 231 | 92 | 82 | 12,7 | 10,0 |
| DZR140125SDR11 | 140 x 125 | 231 | 92 | 87 | 12,7 | 11,4 |
| DZR16090SDR11 | 160 x 90 | 251 | 98 | 79 | 14,6 | 8,2 |
| DZR160110SDR11 | 160 x 110 | 251 | 98 | 82 | 14,6 | 10,0 |
| DZR160125SDR11 | 160 x 125 | 251 | 98 | 87 | 14,6 | 11,4 |
| DZR160140SDR11 | 160 x 140 | 251 | 98 | 92 | 14,6 | 12,7 |
| DZR180110SDR11 | 180 x 110 | 261 | 105 | 82 | 16,4 | 10,0 |
| DZR180125SDR11 | 180 x 125 | 261 | 105 | 87 | 16,4 | 11,4 |
| DZR180140SDR11 | 180 x 140 | 261 | 105 | 92 | 16,4 | 12,7 |
| DZR180160SDR11 | 180 x 160 | 261 | 105 | 98 | 16,4 | 14,6 |
| DZR200110SDR11 | 200 x 110 | 274 | 112 | 82 | 18,2 | 10,0 |
| DZR200140SDR11 | 200 x 140 | 282 | 112 | 92 | 18,2 | 12,7 |
| DZR200160SDR11 | 200 x 160 | 282 | 112 | 98 | 18,2 | 14,6 |
| DZR200180SDR11 | 200 x 180 | 282 | 112 | 105 | 18,2 | 16,4 |
| DZR225110SDR11 | 225 x 110 | 292 | 120 | 82 | 20,5 | 10,0 |
| DZR225160SDR11 | 225 x 160 | 292 | 120 | 98 | 20,5 | 14,6 |
| DZR225180SDR11 | 225 x 180 | 292 | 120 | 105 | 20,5 | 16,4 |
| DZR225200SDR11 | 225 x 200 | 292 | 120 | 112 | 20,5 | 18,2 |
| DZR250160SDR11 | 250 x 160 | 295 | 129 | 98 | 22,7 | 14,6 |
| DZR250180SDR11 | 250 x 180 | 307 | 129 | 105 | 22,7 | 16,4 |
| DZR250200SDR11 | 250 x 200 | 307 | 129 | 112 | 22,7 | 18,2 |
| DZR250225SDR11 | 250 x 225 | 312 | 129 | 120 | 22,7 | 20,5 |
| DZR280180SDR11 | 280 x 180 | 344 | 139 | 105 | 25,4 | 26,4 |
| DZR280200SDR11 | 280 x 200 | 344 | 139 | 112 | 25,4 | 28,2 |
| DZR280225SDR11 | 280 x 225 | 344 | 139 | 120 | 25,4 | 30,5 |
| DZR280250SDR11 | 280 x 250 | 350 | 139 | 129 | 25,4 | 33,2 |
| DZR315225SDR11 | 315 x 225 | 345 | 150 | 120 | 28,6 | 20,5 |
| DZR315250SDR11 | 315 x 250 | 385 | 150 | 129 | 28,6 | 22,7 |
| DZR315280SDR11 | 315 x 280 | 385 | 150 | 139 | 28,6 | 25,4 |

REDUKCJA SDR 17 PE100
REDUCER SDR 17 PE100

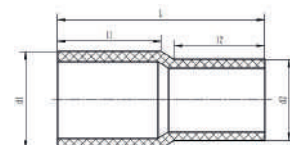

| Nr kat. | D (mm) | l | l1 | l2 | s1 | s2 |
|----------------|-----------|-----|-----|-----|------|------|
| DZR7563SDR17 | 75 x 63 | 175 | 70 | 63 | 4,5 | 3,8 |
| DZR9063SDR17 | 90 x 63 | 195 | 79 | 63 | 5,4 | 3,8 |
| DZR9075SDR17 | 90 x 75 | 195 | 79 | 70 | 5,4 | 4,5 |
| DZR11063SDR17 | 110 x 63 | 213 | 82 | 63 | 6,6 | 3,8 |
| DZR11075SDR17 | 110 x 75 | 213 | 82 | 70 | 6,6 | 4,5 |
| DZR11090SDR17 | 110 x 90 | 213 | 82 | 79 | 6,6 | 5,4 |
| DZR12563SDR17 | 125 x 63 | 220 | 87 | 63 | 7,4 | 3,8 |
| DZR12575SDR17 | 125 x 75 | 220 | 87 | 70 | 7,4 | 4,5 |
| DZR12590SDR17 | 125 x 90 | 220 | 87 | 79 | 7,4 | 5,4 |
| DZR125110SDR17 | 125 x 110 | 220 | 87 | 82 | 7,4 | 6,6 |
| DZR14075SDR17 | 140 x 75 | 231 | 92 | 70 | 8,3 | 4,5 |
| DZR14090SDR17 | 140 x 90 | 231 | 92 | 79 | 8,3 | 5,4 |
| DZR140110SDR17 | 140 x 110 | 231 | 92 | 82 | 8,3 | 6,6 |
| DZR140125SDR17 | 140 x 125 | 231 | 92 | 87 | 8,3 | 7,4 |
| DZR16090SDR17 | 160 x 90 | 251 | 98 | 79 | 9,5 | 5,4 |
| DZR160110SDR17 | 160 x 110 | 251 | 98 | 82 | 9,5 | 6,6 |
| DZR160125SDR17 | 160 x 125 | 251 | 98 | 87 | 9,5 | 7,4 |
| DZR160140SDR17 | 160 x 140 | 251 | 98 | 92 | 9,5 | 8,3 |
| DZR180110SDR17 | 180 x 110 | 261 | 105 | 82 | 10,7 | 6,6 |
| DZR180125SDR17 | 180 x 125 | 261 | 105 | 87 | 10,7 | 7,4 |
| DZR180140SDR17 | 180 x 140 | 261 | 105 | 92 | 10,7 | 8,3 |
| DZR180160SDR17 | 180 x 160 | 261 | 105 | 98 | 10,7 | 9,5 |
| DZR200110SDR17 | 200 x 110 | 274 | 112 | 82 | 11,9 | 6,6 |
| DZR200140SDR17 | 200 x 140 | 282 | 112 | 92 | 11,9 | 8,3 |
| DZR200160SDR17 | 200 x 160 | 282 | 112 | 98 | 11,9 | 9,5 |
| DZR200180SDR17 | 200 x 180 | 282 | 112 | 105 | 11,9 | 10,7 |
| DZR225110SDR17 | 225 x 110 | 292 | 120 | 82 | 13,4 | 6,6 |
| DZR225160SDR17 | 225 x 160 | 292 | 120 | 98 | 13,4 | 9,5 |
| DZR225180SDR17 | 225 x 180 | 292 | 120 | 105 | 13,4 | 10,7 |
| DZR225200SDR17 | 225 x 200 | 292 | 120 | 112 | 13,4 | 11,9 |
| DZR250160SDR17 | 250 x 160 | 295 | 129 | 98 | 14,8 | 9,5 |
| DZR250180SDR17 | 250 x 180 | 307 | 129 | 105 | 14,8 | 10,7 |
| DZR250200SDR17 | 250 x 200 | 307 | 129 | 112 | 14,8 | 11,9 |
| DZR250225SDR17 | 250 x 225 | 312 | 129 | 120 | 14,8 | 13,4 |
| DZR280180SDR17 | 280 x 180 | 344 | 139 | 105 | 16,6 | 10,7 |
| DZR280200SDR17 | 280 x 200 | 344 | 139 | 112 | 16,6 | 11,9 |
| DZR280225SDR17 | 280 x 225 | 344 | 139 | 120 | 16,6 | 13,4 |
| DZR280250SDR17 | 280 x 250 | 350 | 139 | 129 | 16,6 | 14,8 |
| DZR315225SDR17 | 315 x 225 | 345 | 150 | 120 | 18,7 | 13,4 |
| DZR315250SDR17 | 315 x 250 | 385 | 150 | 129 | 18,7 | 14,8 |
| DZR315280SDR17 | 315 x 280 | 385 | 150 | 139 | 18,7 | 16,6 |

**ZAŚLEPKA SDR11 PE100
END CAP SPIGOT SDR11 PE100**

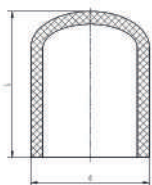

| Nr kat. | D (mm) | l | s |
|-------------|--------|-----|------|
| DZS20SDR11 | 20 | 41 | 3,0 |
| DZS25SDR11 | 25 | 41 | 3,0 |
| DZS32SDR11 | 32 | 44 | 3,0 |
| DZS40SDR11 | 40 | 49 | 3,7 |
| DZS50SDR11 | 50 | 55 | 4,6 |
| DZS63SDR11 | 63 | 63 | 5,8 |
| DZS75SDR11 | 75 | 70 | 6,8 |
| DZS90SDR11 | 90 | 79 | 8,2 |
| DZS110SDR11 | 110 | 82 | 10,0 |
| DZS125SDR11 | 125 | 87 | 11,4 |
| DZS140SDR11 | 140 | 92 | 12,7 |
| DZS160SDR11 | 160 | 98 | 14,6 |
| DZS180SDR11 | 180 | 105 | 16,4 |
| DZS200SDR11 | 200 | 112 | 18,2 |
| DZS225SDR11 | 225 | 120 | 20,5 |
| DZS250SDR11 | 250 | 129 | 22,7 |
| DZS280SDR11 | 280 | 139 | 25,4 |
| DZS315SDR11 | 315 | 150 | 28,6 |
| DZS355SDR11 | 355 | 164 | 32,3 |
| DZS400SDR11 | 400 | 179 | 36,4 |

**ZAŚLEPKA SDR17 PE100
END CAP SPIGOT SDR17 PE100**

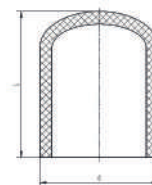

| Nr kat. | D (mm) | l | s |
|-------------|--------|-----|------|
| DZS63SDR17 | 63 | 63 | 3,8 |
| DZS75SDR17 | 75 | 70 | 4,5 |
| DZS90SDR17 | 90 | 79 | 5,4 |
| DZS110SDR17 | 110 | 82 | 6,6 |
| DZS125SDR17 | 125 | 87 | 7,4 |
| DZS140SDR17 | 140 | 92 | 8,3 |
| DZS160SDR17 | 160 | 98 | 9,5 |
| DZS180SDR17 | 180 | 105 | 10,7 |
| DZS200SDR17 | 200 | 112 | 11,9 |
| DZS225SDR17 | 225 | 120 | 13,4 |
| DZS250SDR17 | 250 | 129 | 14,8 |
| DZS280SDR17 | 280 | 139 | 16,6 |
| DZS315SDR17 | 315 | 150 | 18,7 |
| DZS350SDR17 | 350 | 164 | 21,1 |
| DZS400SDR17 | 400 | 179 | 23,7 |

**TULEJA KOŁNIERZOWA SDR11 PE100
STUB END SDR11 PE100**

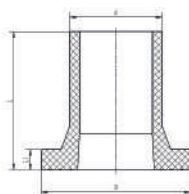

| Nr kat. | D (mm) | d1 | d2 | l | l1 | z | s |
|-------------|--------|-----|-----|-----|----|-----|------|
| DTK20SDR11 | 20 | 28 | 45 | 41 | 7 | 76 | 3,0 |
| DTK25SDR11 | 25 | 34 | 58 | 41 | 9 | 81 | 3,0 |
| DTK32SDR11 | 32 | 42 | 68 | 44 | 10 | 85 | 3,0 |
| DTK40SDR11 | 40 | 48 | 78 | 49 | 11 | 88 | 3,7 |
| DTK50SDR11 | 50 | 58 | 88 | 55 | 12 | 92 | 4,6 |
| DTK63SDR11 | 63 | 78 | 102 | 63 | 14 | 100 | 5,8 |
| DTK75SDR11 | 75 | 92 | 122 | 70 | 16 | 120 | 6,8 |
| DTK90SDR11 | 90 | 108 | 138 | 79 | 17 | 132 | 8,2 |
| DTK110SDR11 | 110 | 128 | 158 | 82 | 18 | 157 | 10,0 |
| DTK125SDR11 | 125 | 135 | 158 | 87 | 25 | 170 | 11,4 |
| DTK140SDR11 | 140 | 158 | 188 | 92 | 25 | 175 | 12,7 |
| DTK160SDR11 | 160 | 178 | 212 | 98 | 25 | 180 | 14,6 |
| DTK180SDR11 | 180 | 188 | 212 | 105 | 30 | 190 | 16,4 |
| DTK200SDR11 | 200 | 235 | 268 | 112 | 32 | 200 | 18,2 |
| DTK225SDR11 | 225 | 238 | 268 | 120 | 32 | 200 | 20,5 |
| DTK250SDR11 | 250 | 288 | 320 | 129 | 35 | 205 | 22,7 |
| DTK280SDR11 | 280 | 294 | 320 | 139 | 35 | 215 | 25,4 |
| DTK315SDR11 | 315 | 338 | 370 | 150 | 35 | 220 | 28,6 |
| DTK355SDR11 | 355 | 376 | 430 | 164 | 40 | 243 | 32,3 |
| DTK400SDR11 | 400 | 430 | 480 | 179 | 46 | 259 | 36,4 |
| DTK450SDR11 | 450 | 517 | 585 | 195 | 60 | 301 | 40,9 |
| DTK500SDR11 | 500 | 533 | 585 | 212 | 60 | 314 | 45,5 |
| DTK560SDR11 | 560 | 618 | 685 | 235 | 72 | 345 | 50,9 |
| DTK630SDR11 | 630 | 645 | 685 | 255 | 65 | 360 | 57,3 |

**TULEJA KOŁNIERZOWA SDR17 PE100
STUB END SDR17 PE100**

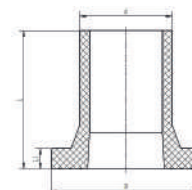

| | D (mm) | l | le1 | le2 | z | s1 | s2 |
|--------------|--------|------|------|-----|----|-----|------|
| DTK63SDR17 | 63 | 78 | 102 | 63 | 14 | 98 | 3,8 |
| DTK75SDR17 | 75 | 92 | 122 | 70 | 16 | 107 | 4,5 |
| DTK90SDR17 | 90 | 108 | 138 | 79 | 17 | 116 | 5,4 |
| DTK110SDR17 | 110 | 128 | 158 | 82 | 17 | 128 | 6,6 |
| DTK125SDR17 | 125 | 135 | 158 | 87 | 18 | 132 | 7,4 |
| DTK140SDR17 | 140 | 158 | 188 | 92 | 18 | 142 | 8,3 |
| DTK160SDR17 | 160 | 178 | 212 | 98 | 18 | 145 | 9,5 |
| DTK180SDR17 | 180 | 188 | 212 | 105 | 20 | 150 | 10,7 |
| DTK200SDR17 | 200 | 235 | 268 | 112 | 24 | 174 | 11,9 |
| DTK225SDR17 | 225 | 238 | 268 | 120 | 24 | 179 | 13,4 |
| DTK250SDR17 | 250 | 288 | 320 | 129 | 25 | 195 | 14,8 |
| DTK280SDR17 | 280 | 294 | 320 | 139 | 25 | 205 | 16,6 |
| DTK315SDR17 | 315 | 338 | 370 | 150 | 25 | 216 | 18,7 |
| DTK355SDR17 | 355 | 376 | 430 | 164 | 30 | 233 | 21,1 |
| DTK400SDR17 | 400 | 430 | 480 | 179 | 33 | 246 | 23,7 |
| DTK450SDR17 | 450 | 517 | 585 | 195 | 46 | 287 | 26,7 |
| DTK500SDR17 | 500 | 533 | 585 | 212 | 46 | 300 | 29,7 |
| DTK560SDR17 | 560 | 618 | 685 | 235 | 50 | 330 | 33,2 |
| DTK630SDR17 | 630 | 645 | 685 | 255 | 50 | 340 | 37,4 |
| DTK710SDR17 | 710 | 740 | 800 | 255 | 60 | 350 | 42,1 |
| DTK800SDR17 | 800 | 843 | 900 | 255 | 60 | 350 | 47,4 |
| DTK900SDR17 | 900 | 947 | 1000 | 255 | 65 | 355 | 53,3 |
| DTK1000SDR17 | 1000 | 1050 | 1113 | 255 | 70 | 360 | 59,3 |

**KOŁNIERZ STALOWY POKRYTY PP PN10
COATED STEEL FLANGE PP PN10**

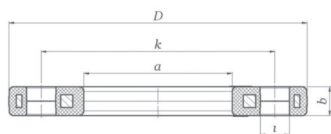

| Nr kat. | d | D | a | k | b | l | SC | DS |
|---------|-----|-----|-----|-----|----|----|-----|----|
| DKS20 | 20 | 95 | 28 | 65 | 12 | 14 | M12 | 4 |
| DKS25 | 25 | 105 | 34 | 75 | 12 | 14 | M12 | 4 |
| DKS32 | 32 | 115 | 42 | 85 | 16 | 14 | M12 | 4 |
| DKS40 | 40 | 140 | 51 | 100 | 16 | 18 | M16 | 4 |
| DKS50 | 50 | 150 | 62 | 110 | 18 | 18 | M16 | 4 |
| DKS63 | 63 | 165 | 78 | 125 | 18 | 18 | M16 | 4 |
| DKS75 | 75 | 188 | 92 | 145 | 18 | 18 | M16 | 4 |
| DKS90 | 90 | 204 | 108 | 160 | 20 | 18 | M16 | 8 |
| DKS110 | 110 | 224 | 128 | 180 | 20 | 18 | M16 | 8 |
| DKS125 | 125 | 224 | 135 | 180 | 20 | 18 | M16 | 8 |
| DKS140 | 140 | 252 | 158 | 210 | 24 | 18 | M16 | 8 |
| DKS160 | 160 | 285 | 178 | 240 | 24 | 22 | M20 | 8 |
| DKS180 | 180 | 285 | 188 | 240 | 24 | 22 | M20 | 8 |
| DKS200 | 200 | 340 | 235 | 295 | 27 | 22 | M20 | 12 |
| DKS225 | 225 | 340 | 238 | 295 | 27 | 22 | M20 | 12 |
| DKS250 | 250 | 419 | 288 | 355 | 32 | 26 | M24 | 12 |
| DKS280 | 280 | 419 | 294 | 355 | 32 | 26 | M24 | 12 |
| DKS315 | 315 | 478 | 338 | 410 | 34 | 26 | M24 | 12 |
| DKS355 | 355 | 532 | 376 | 470 | 42 | 26 | M24 | 16 |
| DKS400 | 400 | 592 | 430 | 525 | 46 | 30 | M27 | 16 |

**KOŁNIERZ STALOWY OCYNKOWANY PN10
GALVANIZED STEEL FLANGE PN 10**



| Nr kat. | d | D | a | k | b | l | SC | DS |
|---------|-----|-----|-----|-----|----|----|-----|----|
| DKK20 | 20 | 95 | 28 | 65 | 12 | 14 | M12 | 4 |
| DKK25 | 25 | 105 | 34 | 75 | 12 | 14 | M12 | 4 |
| DKK32 | 32 | 115 | 42 | 85 | 16 | 14 | M12 | 4 |
| DKK40 | 40 | 140 | 51 | 100 | 16 | 18 | M16 | 4 |
| DKK50 | 50 | 150 | 62 | 110 | 18 | 18 | M16 | 4 |
| DKK63 | 63 | 165 | 78 | 125 | 18 | 18 | M16 | 4 |
| DKK75 | 75 | 188 | 92 | 145 | 18 | 18 | M16 | 4 |
| DKK90 | 90 | 204 | 108 | 160 | 20 | 18 | M16 | 8 |
| DKK110 | 110 | 224 | 128 | 180 | 20 | 18 | M16 | 8 |
| DKK125 | 125 | 224 | 135 | 180 | 20 | 18 | M16 | 8 |
| DKK140 | 140 | 252 | 158 | 210 | 24 | 18 | M16 | 8 |
| DKK160 | 160 | 285 | 178 | 240 | 24 | 22 | M20 | 8 |
| DKK180 | 180 | 285 | 188 | 240 | 24 | 22 | M20 | 8 |
| DKK200 | 200 | 340 | 235 | 295 | 27 | 22 | M20 | 12 |
| DKK225 | 225 | 340 | 238 | 295 | 27 | 22 | M20 | 12 |
| DKK250 | 250 | 419 | 288 | 355 | 32 | 26 | M24 | 12 |
| DKK280 | 280 | 419 | 294 | 355 | 32 | 26 | M24 | 12 |
| DKK315 | 315 | 478 | 338 | 410 | 34 | 26 | M24 | 12 |
| DKK355 | 355 | 532 | 376 | 470 | 42 | 26 | M24 | 16 |
| DKK400 | 400 | 592 | 430 | 525 | 46 | 30 | M27 | 16 |

**ZŁĄCZE PE/MOSIĄDZ GW SDR11 PE100
PE/BRASS FEMALE SDR11 PE100**

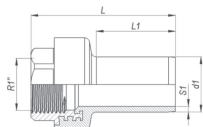

| Nr kat. | Rozmiar | l | l1 | l2 |
|----------|-------------|-----|----|------|
| DGW2012 | 20 x 1/2" | 70 | 41 | 3,0 |
| DGW2034 | 20 x 3/4" | 72 | 41 | 3,0 |
| DGW2534 | 25 x 3/4" | 72 | 41 | 3,0 |
| DGW321 | 32 x 1" | 84 | 44 | 3,0 |
| DGW40114 | 40 x 1 1/4" | 98 | 49 | 3,7 |
| DGW50112 | 50 x 1 1/2" | 101 | 55 | 4,6 |
| DGW632 | 63 x 2" | 115 | 63 | 5,8 |
| DGW75212 | 75 x 2 1/2" | 129 | 70 | 6,8 |
| DGW903 | 90 x 3" | 144 | 79 | 8,2 |
| DGW1104 | 110 x 4" | 147 | 82 | 10,0 |
| DGW1254 | 125 x 4" | 153 | 87 | 11,4 |

**ZŁĄCZE PE/MOSIĄDZ GZ SDR11 PE100
PE/BRASS MALE SDR11 PE100**

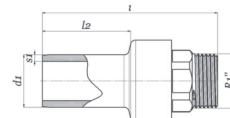

| Nr kat. | Rozmiar | l | l1 | l2 |
|----------|-------------|-----|----|------|
| DGZ2012 | 20 x 1/2" | 84 | 41 | 3,0 |
| DGZ2034 | 20 x 3/4" | 85 | 41 | 3,0 |
| DGZ2534 | 25 x 3/4" | 90 | 41 | 3,0 |
| DGZ321 | 32 x 1" | 103 | 44 | 3,0 |
| DGZ40114 | 40 x 1 1/4" | 122 | 49 | 3,7 |
| DGZ50112 | 50 x 1 1/2" | 122 | 55 | 4,6 |
| DGZ632 | 63 x 2" | 140 | 63 | 5,8 |
| DGZ75212 | 75 x 2 1/2" | 146 | 70 | 6,8 |
| DGZ903 | 90 x 3" | 168 | 79 | 8,2 |
| DGZ1104 | 110 x 4" | 179 | 82 | 10,0 |
| DGZ1254 | 125 x 4" | 186 | 87 | 11,4 |

Akcesoria do zgrzewania

Welding accessories

ZACISK MONTAŻOWY DO RUR PE, PROSTY PE PIPE CLAMMING TOOL, STRAIGHT



Zacisk ten ułatwia prawidłowe zamocowanie elektrozłączki na rurze, zapewniając jej całkowite unieruchomienie podczas całego cyklu zgrzewania oraz fazy studzenia. Elektrozłączka oraz końce rur pozostają idealnie wycentrowane, co ma duże znaczenie dla prawidłowego wykonania zgrzewu. Zakres średnic: 16 - 63 mm.

Tool for centering facilitates proper installation electrofusion fitting on the pipe, ensuring it is completely immobilized during the process of welding cycle and the cooling phase. Electrofusion fitting and ends of the pipes remain perfectly centered, which is important for the proper implementation of the weld. Diameter range: 16 - 63 mm.

ZACISK MONTAŻOWY DO RUR PE, UNIWERSALNY PE PIPE CLAMMING TOOL, UNIVERSAL



Zacisk montażowy uniwersalny stosuje się przy zgrzewaniu elektrozłączek typu mufa, trójnik, kolano 90° oraz kolano 45°. Zakres średnic: 16 - 63 mm

Universal tool for centering is used in the welding electrofusion type of fittings like coupler, tee, elbow 90° and 45°. Diameter range: 16 - 63 mm.

ZACISKACZ ŚRUBOWY DO RUR PE, RĘCZNY MANUAL SQUEEZE-OFF TOOL



Zaciskacz do rur PE służy do zamykania przepływu gazu lub wody w uszkodzonym rurociągu. Zaciskacz posiada tarczę dystansową, która zapobiega uszkodzeniu rury poprzez nadmierne jej ściśnięcie.

Squeeze-off tool for PE pipes is used to shut down the flow of gas or water in a damaged pipeline. Squeeze-off tool have a rotating distance shield that prevents excessive damage to the pipe through the squeeze.

ZACISKACZ DO RUR PE, HYDRAULICZNY HYDRAULIC SQUEEZE-OFF TOOL



Zaciskacz hydrauliczny stosuje się do rur o średnicach powyżej 125 mm. Zaciskacz ten z łatwością zamyka przepływ gazu, a boczne pierścienie zapobiegają nadmiernemu zgnieceniu rury, mogącemu doprowadzić do jej uszkodzenia.

Hydraulic squeeze-off tool apply to pipes with diameters greater than 125 mm. Squeeze-off tool is easy to close the gas flow and side rings prevent excessive crushing of PE pipe likely to lead damage.

SKROBAK DO RUR PE SCRAPER FOR PE PIPES



Skrobak służy do usuwania z powierzchni rury warstwy utlenionego polietylenu. Czynność ta jest obowiązkowa przed przystąpieniem do zgrzewania elektrooporowego.

Scraper used to remove the surface oxidized layer of polyethylene pipe. This operation is obligatory prior to electrofusion welding.

TAŚMA IZOLACYJNA DO RUR ISOLATION TAPE FOR PIPES



Taśma izolacyjna służy do tworzenia powłok antykorozyjnych na podziemnych i naziemnych rurociągach. Przeznaczenie: głównie do izolacji armatury, połączeń kołnierzowych, kielichowych, trójników, śrubunków, ponadto do zabezpieczenia antykorozyjnego gazociągów i wodociągów.

Isolation tape is used to create anti-corrosion coatings on underground and above-ground pipelines. Destiny: mainly for fittings insulation, flange adaptors, sockets, screws, and also for anti-corrosion protection gas and water pipelines.

AUTOMATYCZNY SKROBAK DO RUR PE AUTOMATIC SCRAPER FOR PE PIPES



Automatyczny skrobak do rur PE jest przyrządem zapewniającym szybkie i łatwe oczyszczenie rury z utlenionego polietylenu. Ostrze skrobaka porusza się w osi rury po śrubie prowadzącej, przez co zdzieranie warstwy polietylenu odbywa się torem spiralnym. Mechanizm sprężynujący zapewnia prawidłowy docisk ostrza do powierzchni rury.

Automatic PE pipes scraper is a tool to provide quick and easy cleaning of the oxidized polyethylene pipe. The scraper blade moves in the axis of the pipe along the screwleading, thereby peeling off the polyethylene layer takes place in a spiral path. Spring mechanism ensures the correct pressure of the blade to the surface of the pipe.



Posiadamy następujące certyfikaty

We have the following certificates

Certyfikat DVGW na złączki elektrooporowe rozmiar 25-630 mm



Certyfikat DVGW na kształtki doczołowe wtryskowe



Atest Higieniczny Państwowego Zakładu Higieny na złączki polietylenowe elektrooporowe klasy PE100 SDR11 i DSR17



Atest Higieniczny Państwowego Zakładu Higieny na kształtki doczołowe wtryskowe



Certyfikat WRAS na złączki polietylenowe elektrooporowe klasy PE100 SDR11 i DSR17



Certyfikat WRAS na kształtki doczołowe wtryskowe



MPJ SP. Z O.O.

ul. Jana Kasprwicza 15

20-232 Lublin

NIP: 946-265-47-81

tel. +48 81 472 22 22

fax +48 81 472 20 00

Biuro:

e-mail: info@mpj.pl

Marketing:

e-mail: marketing@mpj.pl

Produkcja:

e-mail: produkcja@mpj.pl

Dyrekcja:

e-mail: dyrekcja@mpj.pl



